

# Door Stay Locking Pins

Your vehicle is fitted with locking pins that enable you to lock off the original Renault door stays if required, for example in strong winds, or when parked on steep inclines.

## Operation

A bracket has been fitted around each door stay which has two holes through which the pin can be inserted.

With the original Renault door stay engaged in the locked position, the pin can be inserted to prevent the door stay, and therefore the door from moving.

When the doors need to be closed, remove the pin and close the door as normal. The pin is retained near the door stays by a chain so it cannot be misplaced.

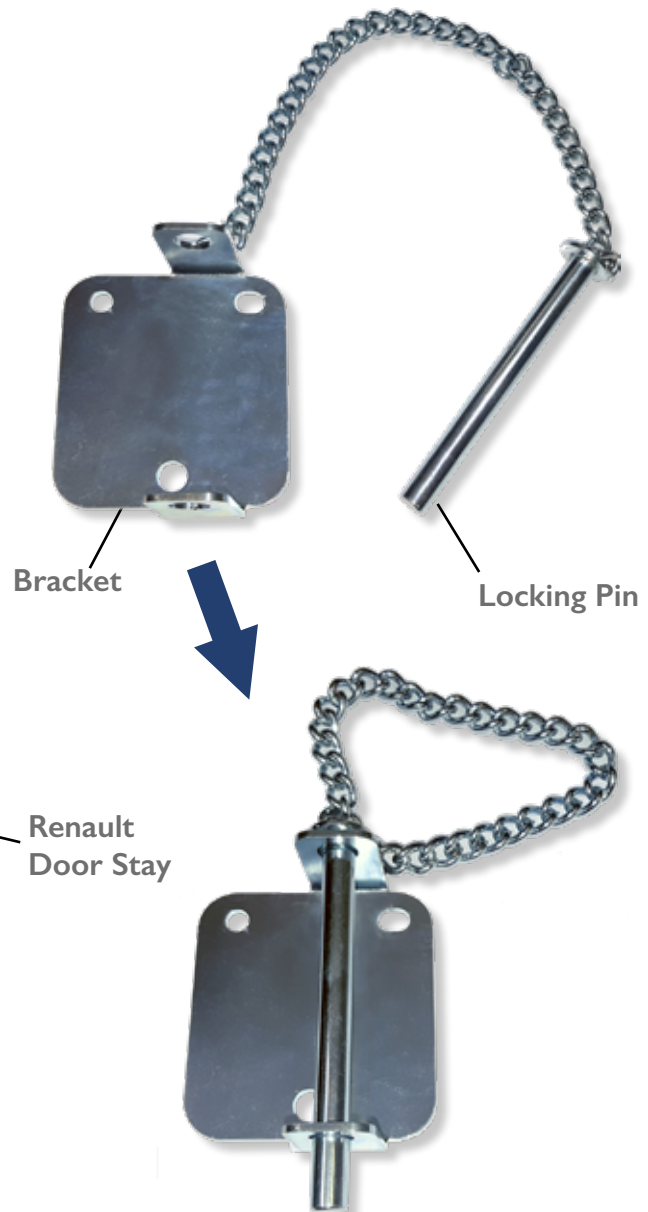

## Important Safety Notes

Please read and understand the full operating instructions supplied by the manufacturer.

**Do not** attempt to close the door when the pins are engaged.

**Do not** lock the doors in the open position for travelling in the vehicle.

If you have any questions about your vehicle, please do not hesitate to call us on **01924 442386** or email [customerservices@bristolstreetversa.com](mailto:customerservices@bristolstreetversa.com)